

# MS Cyrano de Bergerac

5 anchors - Gironde, Garonne, Dordogne - 87 cabins



# MS Cyrano de Bergerac

The MS Cyrano de Bergerac cruises along the Gironde, Garonne and Dordogne.

## Interior design



## Cabins

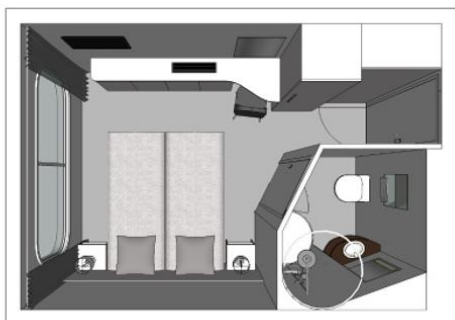

- Middle Deck 1 double bed 8 m<sup>2</sup>
- Upper Deck 2 beds - disabled person 13 m<sup>2</sup>
- Middle deck 2 adjustable twin beds 13 m<sup>2</sup>
- Main Deck 1 double bed 8 m<sup>2</sup>
- Main deck 2 adjustable twin beds 13 m<sup>2</sup>
- Upper Deck 1 double bed 8 m<sup>2</sup>
- Upper deck 2 adjustable twin beds 13 m<sup>2</sup>

## Cabins equipments

- TV
- Telephone (for internal calls only)
- Bathroom with shower and toilet
- Towels
- Safe
- Independent air-conditioning
- Electricity 220V
- Wi-Fi

Please note that there is no laundry service on board the ship.

## Decks and technical details

### MAIN DECK 25

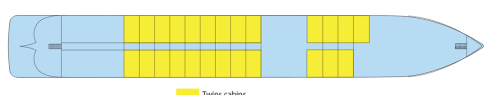

### MIDDLE DECK 21 cabins



### UPPER DECK 41 cabins

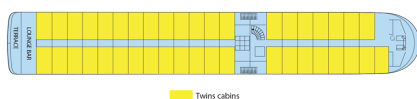

**Number of cabin decks : 3**  
**Number of cabins : 87**  
**Width : 11.40**  
**Year Built : 2013**  
**Guest capacity : 174**  
**Length : 110**  
**Number of crew members : 25**  
**Elevators**  
**Cabin for Mobility Impaired**  
**Cabins outside**

## SUN DECK

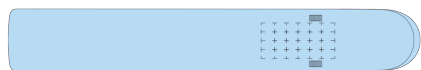

**MIDDLE DECK :** RESTAURANT - RECEPTION DESK - LOUNGE BAR WITH DANCEFLOOR

**UPPER DECK :** PIANORAMABAR - TERRACE

**SUN DECK :** FITNESS - SUN DECK